

THESE DRAWINGS AND SPECIFICATIONS ARE THE PROPERTY OF JBL. INCORPORATED. THEY ARE ISSUED IN STRICT CONFIDENCE AND SHALL NOT BE REPRODUCED OR USED AS THE BASIS FOR MANUFACTURE OR REPAIRS WITHOUT WRITTEN PERMISSION.

REVISIONS			
CHG	INTR	DESCRIPTION	DATE
30258	A	RELEASE TO MARKETING	10/25/2004
38767	B	ADDED DOCUMENT NUMBER	AR

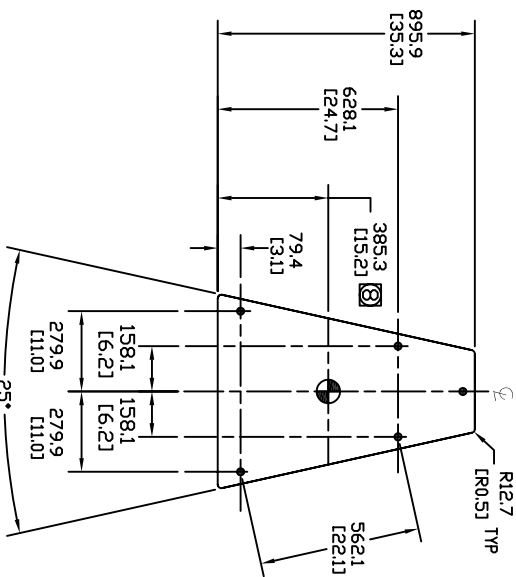

TOP
(BOTTOM SAME)

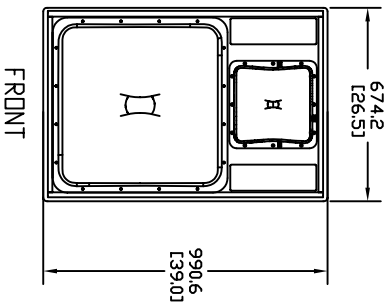

SIDES

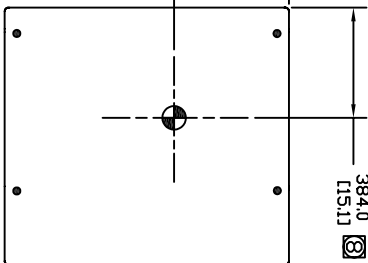

REAR

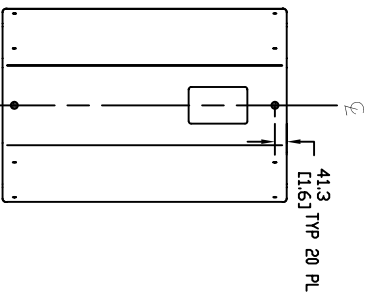

1. COMPONENTS: LF - 2X 2206H; MF - 1X CMCD82H; HF - 1X 2431H
2. INPUT CONNECTORS: 8 TERMINAL BARRIER STRIP AND 1X NEUTRK NL8 SPEAKON.
3. GRILL: 14 GA. PERFORATED CRS, POWDERCOATED BLACK, BLACK FOAM BACKING.
4. MATERIALS: 16MM (5/8") FINISH BIRCH PLYWOOD.
5. FINISH: BLACK DURAFLEX
6. SUSPENSION POINTS: "•" 20 TOTAL; 5 EA TOP AND BOTTOM, 4 EA SIDE, 2 REAR;
7. WEIGHT: 83.9 kg (185 LBS)
8. CENTER OF GRAVITY (CG) •

NOTES: (UNLESS OTHERWISE SPECIFIED)

TOLERANCES

- UNLESS OTHERWISE SPECIFIED
- XX ± .003 INCH
- XX ± .005 INCH
- ANGULAR TOLERANCE OF 0°±30°
- FRACTIONAL DIMENSIONS ± 1/32
- ALL DIMENSIONS ARE FINISHED DIMENSIONS
- DO NOT SCALE DRAWING

JBL PROFESSIONAL
A Harman International Company
Northridge, California 91329 U.S.A.

TITLE
PD5322/43

SIZE
A
DRAWING NO.
444324
REV
B

SCALE
NTS
SHEET 1 OF 1